

# PRODUCT INFORMATION PACKET

Model No: 048A11O1352  
Catalog No: X020  
1/2,1075,OPAO,48Y,1/60/277  
Direct Drive



Regal and Marathon are trademarks of Regal Beloit Corporation or one of its affiliated companies.  
©2018 Regal Beloit Corporation, All Rights Reserved. MC017097E



**Nameplate Specifications**

|                            |                      |                        |                                  |
|----------------------------|----------------------|------------------------|----------------------------------|
| Output HP                  | <b>0.50 Hp</b>       | Output KW              | <b>0.37 kW</b>                   |
| Frequency                  | <b>60 Hz</b>         | Voltage                | <b>277 V</b>                     |
| Current                    | <b>3.6 A</b>         | Speed                  | <b>1075 rpm</b>                  |
| Service Factor             | <b>1</b>             | Phase                  | <b>1</b>                         |
| Efficiency                 | <b>69 %</b>          | Duty                   | <b>Continuous</b>                |
| Insulation Class           | <b>B</b>             | Design Code            | <b>NO DESIGN CODE</b>            |
| KVA Code                   | <b>D</b>             | Frame                  | <b>48Y</b>                       |
| Enclosure                  | <b>Open Air Over</b> | Overload Protector     | <b>Automatic Lock Rotor Only</b> |
| Ambient Temperature        | <b>40 °C</b>         | Drive End Bearing Size | <b>6203</b>                      |
| Opp Drive End Bearing Size | <b>6203</b>          | UL                     | <b>Recognized</b>                |
| CSA                        | <b>Y</b>             | CE                     | <b>N</b>                         |
| IP Code                    | <b>10</b>            |                        |                                  |

**Technical Specifications**

|                       |                                        |                       |                                   |
|-----------------------|----------------------------------------|-----------------------|-----------------------------------|
| Electrical Type       | <b>Permanent Split Capacitor</b>       | Starting Method       | <b>Across The Line</b>            |
| Poles                 | <b>6</b>                               | Rotation              | <b>Selective Counterclockwise</b> |
| Mounting              | <b>Resilient Ring - Extended Studs</b> | Motor Orientation     | <b>Horizontal</b>                 |
| Drive End Bearing     | <b>Ball</b>                            | Opp Drive End Bearing | <b>Ball</b>                       |
| Frame Material        | <b>Rolled Steel</b>                    | Shaft Type            | <b>Single Special Extension</b>   |
| Overall Length        | <b>10.50 in</b>                        | Frame Length          | <b>5.00 in</b>                    |
| Shaft Diameter        | <b>0.500 in</b>                        | Shaft Extension       | <b>4.06 in</b>                    |
| Assembly/Box Mounting | <b>F1 Only</b>                         |                       |                                   |
| Outline Drawing       | <b>A-SS403608-500</b>                  | Connection Diagram    | <b>6906493</b>                    |

**This is an uncontrolled document once printed or downloaded and is subject to change without notice. Date Created: 10/08/2018**

TERM. END

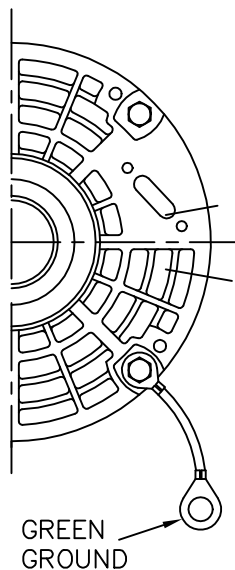

LEADS & BUSHINGS

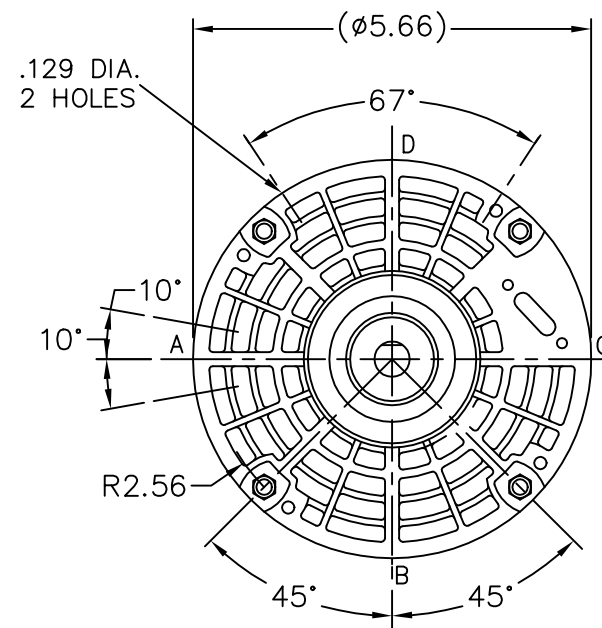
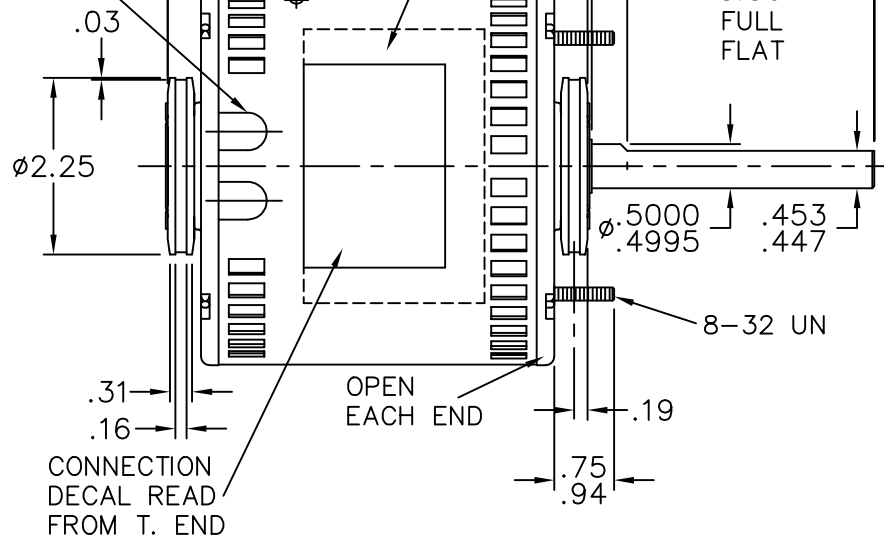

| DASH | FR. | C     | A    |
|------|-----|-------|------|
| 400  | 48Y | 10.00 | 5.00 |
| 475  | 48Y | 10.25 | 5.25 |
| 500  | 48Y | 10.50 | 5.50 |
| 525  | 48Y | 10.75 | 5.75 |

10/1/2008  
10/1/2008  
10/20/2008

LEAD DESCRIPTION:

1 WHITE, 1 BLACK, 1 BLUE, & 1 RED LEAD WITH .50 BARE WIRE STRIP. 30.00" LONG.

2 BROWN LEADS WITH .25 FLAG-TYPE QUICK CONNECTS, 30.00" LONG. BROWN/WHITE MARKED LEAD IS COMMON TO WHITE.

REVERSING LEADS ARE MOLDED INTO MATING PULL-APART PLUGS. 1 YELLOW & 1 PURPLE LEAD PER PLUG. 5.00" LONG.

GREEN LEAD WITH TERM. FOR #10 SCREW 12.00" LONG.

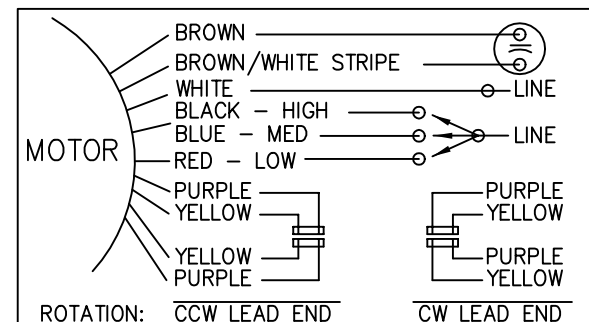

ROTATION: CCW LEAD END

CW LEAD END

| NO. | REVISION                    | BY & DATE     | CHK | ANG   | TOLERANCES UNLESS SPECIFIED |        |
|-----|-----------------------------|---------------|-----|-------|-----------------------------|--------|
|     |                             |               |     |       | DEC.                        | INCHES |
|     |                             |               |     |       | .X                          | ±.1    |
|     |                             |               |     |       | .XX                         | ±.03   |
| 02  | FEW MORE DASH VALUES ADDED. | SP 7/7/2008   | NB  | .XXX  | ±.005                       |        |
| 01  | DASH VALUE ADDED.           | SP 05-20-2008 | NB  | .XXXX | ±.0005                      |        |
|     |                             |               |     |       | ±7'30"                      |        |

**MARATHON ELECTRIC**

TITLE OUTLINE

MAT'L.

FINISH

|                     |
|---------------------|
| DRAWN NB 05-15-2007 |
| CHK VL 05-20-2007   |
| APPD VL 05-20-2007  |
| SCALE 3=8           |
| REF SS75119         |
| FMF MU79124         |
| PREV                |

|                |                   |        |                      |         |         |
|----------------|-------------------|--------|----------------------|---------|---------|
| RFP 05-20-2007 | CAD FILE ss403608 | SIZE A | DRAWING NO. SS403608 | PAGE OF | REV. 02 |
|----------------|-------------------|--------|----------------------|---------|---------|

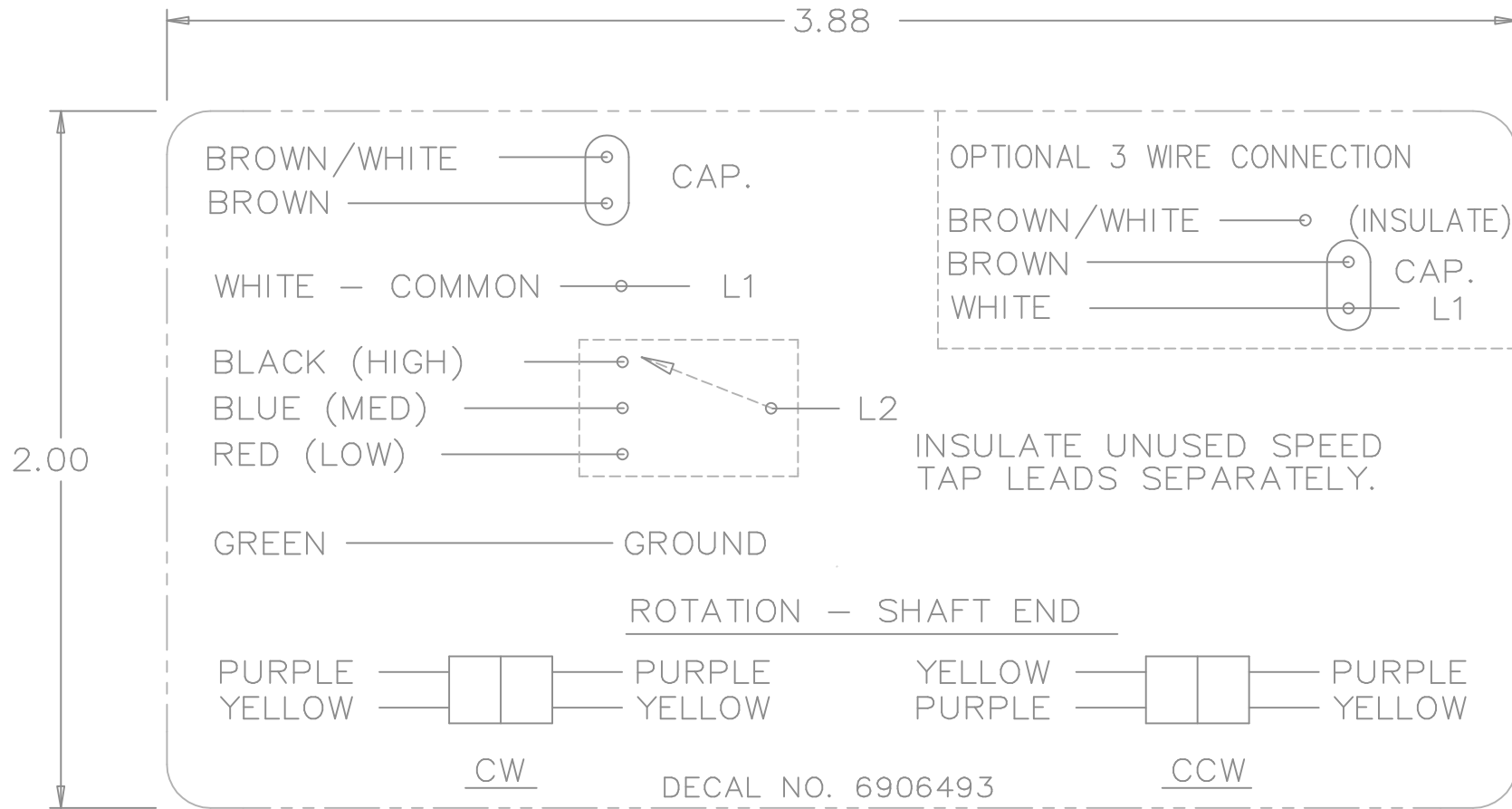

|                                                                                                                                                                                                                                  |                                           |                |     | TOLERANCES UNLESS SPECIFIED |                  | REGAL-BELOIT <i>Motor Technologies</i> | DRAWN MRB 04-16-1998 |             |            |    |      |
|----------------------------------------------------------------------------------------------------------------------------------------------------------------------------------------------------------------------------------|-------------------------------------------|----------------|-----|-----------------------------|------------------|----------------------------------------|----------------------|-------------|------------|----|------|
|                                                                                                                                                                                                                                  |                                           |                |     | DEC.                        | INCHES           |                                        | CHK                  | ML          | 04-22-1998 |    |      |
|                                                                                                                                                                                                                                  |                                           |                |     | .X                          | ±.1              |                                        | APPD                 | GK          | 04-22-1998 |    |      |
| 3                                                                                                                                                                                                                                | REMOVED 'MARATHON ELECTRIC' CN 35106      | DRS 05-01-2002 | TOM | .XX                         | ±                | TITLE CONNECTION DECAL                 | SCALE                | 1=1         |            |    |      |
| 2                                                                                                                                                                                                                                | PART NAME WAS CONNECTION DIAGRAM CN 25669 | MRB 04-25-1998 |     | .XXX                        | ±.005            |                                        | REF                  |             |            |    |      |
| 1                                                                                                                                                                                                                                | NEW DRAWING CN 25669                      | MRB 04-22-1998 |     | .XXXX                       | ±.0005           | MAT'L.                                 | FMF                  |             |            |    |      |
| NO.                                                                                                                                                                                                                              | REVISION                                  | BY & DATE      | CHK | ANG                         | ±                | FINISH                                 | PREV                 |             |            |    |      |
| THIS DRAWING IN DESIGN AND DETAIL IS OUR PROPERTY AND MUST NOT BE USED EXCEPT IN CONNECTION WITH OUR WORK ALL RIGHTS OF DESIGN AND INVENTION ARE RESERVED THIS IS AN ELECTRONICALLY GENERATED DOCUMENT - DO NOT SCALE THIS PRINT |                                           |                |     | RFP                         | CAD FILE 6906493 |                                        | SIZE                 | DRAWING NO. | PAGE       | OF | REV. |
|                                                                                                                                                                                                                                  |                                           |                |     | DIST                        | WP               |                                        | A                    | 6906493     |            |    | 3    |



\*\* Subject to change without notice.